

METAL 2-WAY 20 NOZZLE OSCILLATING SPRINKLER

Use this manual to familiarize yourself with the various parts and components, the use, handling and features of the sprinkler. Save this manual for future reference.

Get To Know Your Sprinkler

- | | |
|-------------------------------|----------------------|
| 1. Base | 5. Flow Control Knob |
| 2. Spray nozzles (20) | 6. Hose-end |
| 3. Oscillator tube | 7. Inlet filter |
| 4. Range Control Sliding Tabs | 8. Cleaning pin |

Specifications

Plastic nozzle heads :	20
Adjustable range control :	Yes
Coverage Max :	3328 sq ft (309 m ²)
	(Based on 40PSI / 2.76Bar)

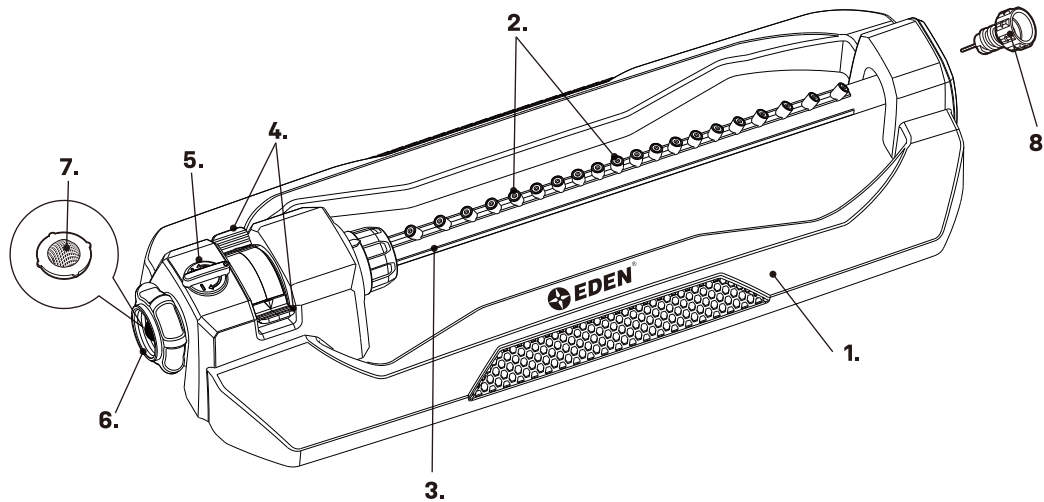

Usage

1. Attach your garden hose to the sprinkler.
2. Use range control sliding tabs to select desired rectangular watering distance. (Fig 1)
3. Turn water flow control knob to regulate water pressure. (Fig 2)
4. Turn on the faucet. Make adjustments to suit your needs.

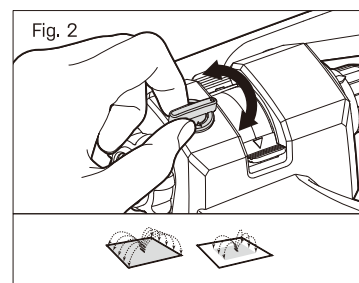
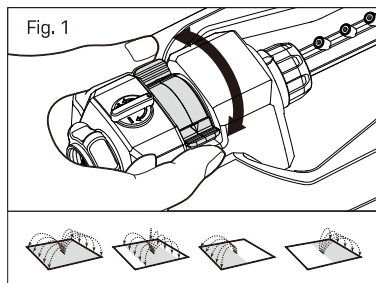

Maintenance + Care

If your sprinkler begins to display irregular water pressure or is clogged due to dirt buildup, do the following maintenance task.

1. Remove your hose from your sprinkler. Notice a small inlet filter from the hose-end of the oscillator, remove it and run under water to remove the dirt (Fig. 3).

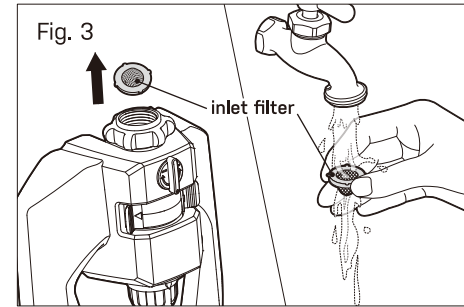

2. To flush, connect the oscillator to a faucet. Turn on the faucet and while the water continues running, spin the tube gently back and forth for few minutes (Fig 4)

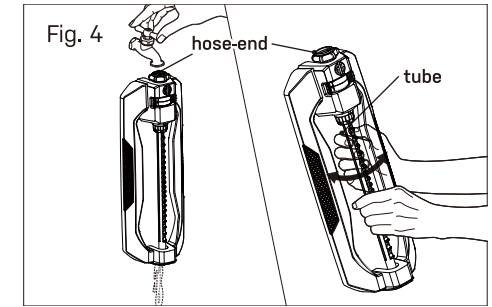

3. Remove the cleaning pin from the opposite end of the oscillator (Fig. 5).

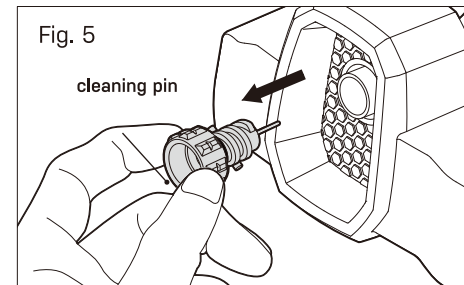

4. Use the provided cleaning pin to clear any clogs from the spray nozzles while running water in step 2 (Fig. 6).

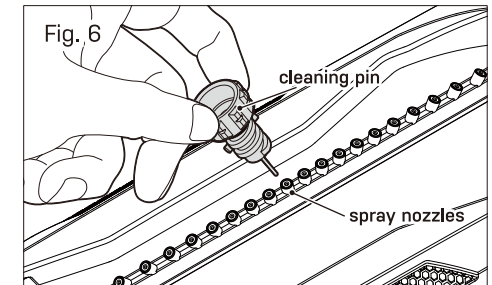

Storage

Drain the sprinkler after use. DO NOT allow water to freeze in the sprinkler (Fig. 7).

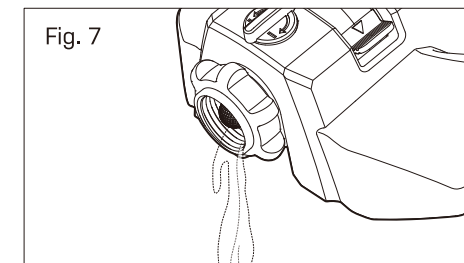

Tips

1. Think of the best coverage design for the watering without wasting water resources before placing the sprinkler in the location where you want to water.
2. Drain any water from the sprinkler after use. This will preserve the unit for longer lasting use.
3. Place the sprinkler in a dry warm storage area until it is required.
4. Water only when necessary, preferably in the morning as this will minimize water loss through evaporation. To obtain deep root growth, water deeply but do not water often. Watering every second day will provide for better water coverage. Using a timer can be helpful in reducing waste. Watch water application to avoid water run-off.

WARNING:

Intended for outdoor agricultural or horticultural use only. This is not a toy. Severe electrical shock could result if water is sprayed into outlets or sources of electrical current. Do not use water more than 115°F (46°C). Do not use when the ambient air temperature is less than 40°F (4.5°C). When not in use, drain and store indoors away from freezing temperatures.

⚠️WARNING: This product can expose you to chemicals including styrene, which is known to the State of California to cause cancer. For more information go to www.P65Warnings.ca.gov

The Quick Connect Adapter (2 pcs) and Hose Connector with Water Stop (1 pc) simplify your watering experience. Simply attach the connector at the end of your hose. Then, connect the adapters to your watering tools. Interchange various tools in a snap without turning off the water as the adapter will stop the water flow. No more kinking or hose twisting as the adapter allows the hose to swivel 360 degrees.

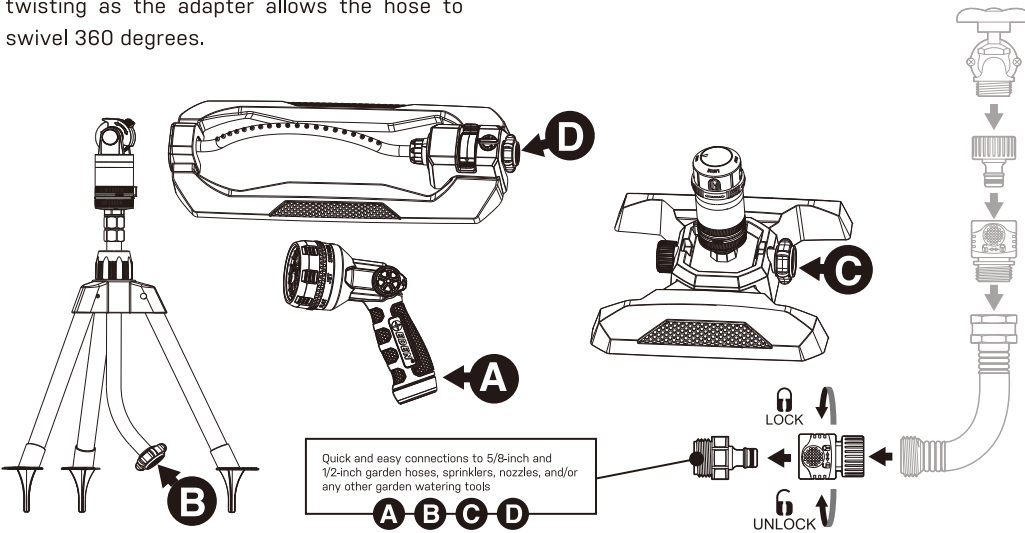

Perfect for watering lawns and gardens



Vegetables



Fruits



Lawn



Agricultural



Horticultural



Garden



94111EDAMZ



**QUESTIONS? CONCERNS?
We're here to help!**

Contact our reliable, US-based Customer Service

support@edengarden.com

1+ 866-521-7718



METAL 2-WAY 20 NOZZLE OSCILLATING SPRINKLER

- Coverage up to 3328 sq ft (309 m²) (Based on 40 PSI / 2.78 Bar)
- 20 Durable nozzles
- Flow Control Knob
- Range control sliding tabs allow for simple adjustment
- Flexible construction won't break
- Cleaning pin for nozzle unclogging

MELNOR INC., WINCHESTER, VIRGINIA 22603, USA

Made in Taiwan www.edengarden.com