

MULTI-PATTERN SPRINKLER PLUS MISTING SYSTEM

5 spray patterns - Flat, Fan, large, multi and Mist!

Flow through design allows for additional units to be connected in series

Adjustable diameter tabs prevent water waste

Wide H shape platform design for added stability

Filter prevents sediments and dirt from getting into sprinkler

For setup, you can choose Method A or B

Quick Connect Adapter fits most brands of garden hoses



Perfect for watering lawns and gardens



Agricultural



Horticultural



Vegetables



Fruits



Lawn



Garden

Method A

Simply attach the gear driver to the top of the base and connect to your hose



Method B

Connect the adaptor to the base, attach the hose with the quick lockable connector, then simply snap on the water hose to begin using.



LOCK
6 ↔ 6
+
WATER STOP



To extend, simply remove the end-cap and attach another hose and connect another sprinkler.



Spray Coverage and Distance Adjustment

Adjust the range tabs and angle cap to change the spray coverage (from 5° up to 360°) and spraying angle to water just where you need without wasting water.



Spray Pattern Adjustments

Depending on your watering needs, you can manually select from the various pattern settings :

FLAT - The flat pattern will provide a flat wave of water.

FAN - The fan pattern disperses water in a wide fan shape.

MIST - This pattern is useful to cool down a small area.

LARGE - This pattern covers the maximum area.

MULTI - This is a combination of the Flat, Fan and Large patterns.



Level Adjustment Indicator

Higher level will create a higher arc resulting in greater water coverage.

Lower levels will reduce coverage.

Convenient indicators are included to help setup when you need to water again.



WARNING:

Intended for outdoor agricultural or horticultural use only. This is not a toy. Severe electrical shock could result if water is sprayed into outlets or sources of electrical current. Do not use water more than 115°F (46°C). Do not use when the ambient air temperature is less than 40°F (4.5°C). When not in use, drain and store indoors away from freezing temperatures.

 This product can expose you to chemicals including styrene, which is known to the State of California to cause cancer. For more information go to www.P65Warnings.ca.gov

HIGHER LEVEL (+) 0 ~ 3 :

The appearance of gradual reduction in water while providing a more dispersed pattern and further distance.

LEVEL WATER:

The flow is depend on water source. It's the middle point between dispersed and concentrated patterns.

LOWER LEVEL (-) 0 ~ 3 :

Increase water flow while providing a more concentrated direct flow of water.

40 PSI	Large	Multi	Flat	Fan
Radius of Spray	39 ft (12 m)	37 ft (11.5 m)	29 ft (9 m)	27 ft (8.5 m)
Coverage Area up to	4860 sq ft (452 m²)	4470 sq ft (415 m²)	2730 sq ft (250 m²)	2440 sq ft (226 m²)

The Quick Connect Adapter (2 pcs) and Hose Connector with Water Stop (1 pc) simplify your watering experience. Simply attach the connector at the end of your hose. Then, connect the adapters to your watering tools. Interchange various tools in a snap without turning off the water as the adapter will stop the water flow. No more kinking or hose twisting as the adapter allows the hose to swivel 360 degrees.

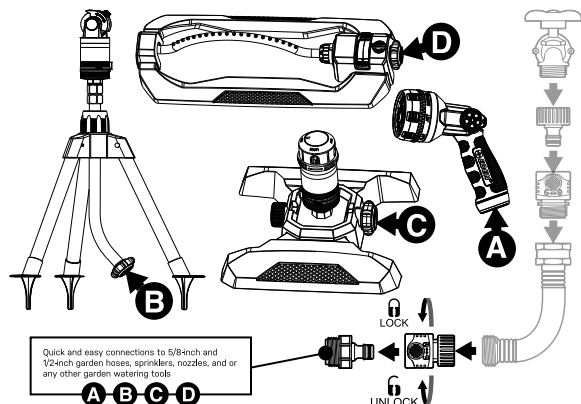

QUESTIONS? CONCERNS?

We're here to help!

Contact our reliable, US-based Customer Service

support@edengarden.com

1+ 866-521-7718

