

MULTI-PATTERN SPRINKLER PLUS MISTING SYSTEM

41.5"
(105cm)



27.5"
(70cm)

Step 1

Place the tripod in the area where you want to water. Push down on the tripod legs until the spikes are well seated in the ground.

(Follow the yellow warning sign on the tripod to avoid pinching your thumb)

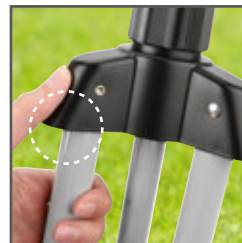

Step 2

Simply attach the sprinkler head to the top of the Tripod (do not overtighten).



Step 3

Use the Quick Connect to easily connect and disconnect the sprinkler from the hose. Connect the Product Adapter to the base of the sprinkler. Attach the lockable Quick Connect to the end of the hose, then simply snap in the hose to the sprinkler to begin using.

Note: If you are not using the Quick Connect System, simply connect the sprinkler directly to the hose.

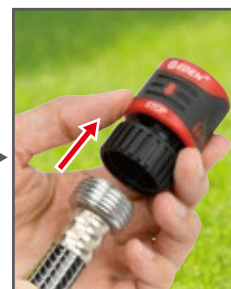

Spray Coverage and Distance Adjustment

Adjust the range tabs and angle cap to change the spray coverage (from 5° up to 360°) and spraying angle to water just where you need.



Quick Connect Starter Set fits standard garden hoses and watering tools



Perfect for watering lawns and gardens



Vegetables



Fruits



Lawn



Agricultural

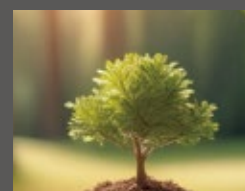

Horticultural



Garden

Spray Pattern Adjustments

Depending on your watering needs, you can manually select from the various pattern settings:

FLAT - The flat pattern will provide a flat wave of water.

FAN - The fan pattern disperses water in a wide fan shape.

MIST - This pattern is useful to water delicate plants. (Does not rotate)

LARGE - This pattern covers the maximum area.

MULTI - This is a combination of the Flat, Fan and Large patterns.



Level Adjustment Indicator

Move the angle cap to control the distance of your watering area. The higher level will create a higher arc for greater water coverage. The lower level will reduce the watering area. Convenient indicators help you remember your settings for next time.



HIGHER LEVEL (1-3):
Adjust the spray upwards for maximum distance.



LEVEL (0)
Adjust the spray in between a dispersed and concentrated watering area.



LOWER LEVEL (3-1)
Adjust the spray downwards to reduce the watering area.

40 PSI	Large	Multi	Flat	Fan
Radius of Spray	39 ft (12 m)	37 ft (11.5 m)	29 ft (9 m)	27 ft (8.5 m)
Coverage Area up to	4860 sq ft (452 m²)	4470 sq ft (415 m²)	2730 sq ft (253.6 m²)	2440 sq ft (226 m²)

WARNING:

Intended for outdoor agricultural or horticultural use only. This is not a toy. Severe electrical shock could result if water is sprayed into outlets or sources of electrical current. Do not use water more than 115°F (46°C). Do not use when the ambient air temperature is less than 40°F (4.5°C). When not in use, drain and store indoors away from freezing temperatures.

⚠WARNING: This product can expose you to chemicals including styrene which is known to the State of California to cause cancer. For more information go to www.P65Warnings.ca.gov.

The Quick Connect Adapter (1 pc) and Hose Connector with Water Stop (1 pc) simplify your watering experience. Simply attach the connector at the end of your hose. Then, connect the adapters to your watering tools. Interchange various tools in a snap without turning off the water as the adapter will stop the water flow. No more kinking or hose twisting as the adapter allows the hose to swivel 360 degrees.



QUESTIONS? CONCERNS?

We're here to help!

Contact our reliable, US-based Customer Service

support@edengarden.com

1+ 866-521-7718

