

# 6-PATTERN ROTARY GEAR DRIVE SPRINKLER WITH TELESCOPING TRIPOD

Tripod  
length  
63.7"  
(162cm)

Range tab - adjust range and prevent water waste

6 spray patterns to meet all your watering needs  
- flat, fan, large, jet, full and mini

Connects to any Eden sprinkler base with "H"  
shape or tripod base

Spray Angle - adjust the tabs to change the spray  
angle from 5° to 360°

Added filter to prevent water sediment

## Step 1

Place the tripod in the area where you want to water. Open the latches to release the legs. Push down on the tripod legs until the legs are well seated on the ground.

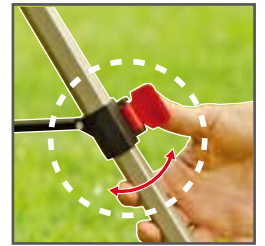

## Step 2

Attach the Extension Tube to the tripod, then connect the sprinkler head to the top of the Tripod or Extension Tube (**do not overtighten**).



## Step 3

Using the Quick Connect with Shut Off Valve allows you to easily shut off the water and swap tools without having to return to the faucet – saving time and water. Attach the lockable Quick Connect to the end of the hose, then snap the hose to the tripod to begin using.

Note: If you are not using the Quick Connect System, connect the sprinkler directly to the hose.

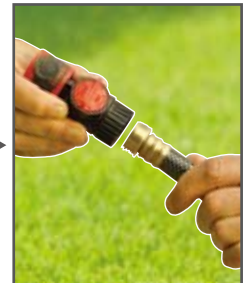

Quick Connect Starter Set  
with Shut Off Valve fits  
standard garden hoses and  
watering tools



43.7"  
(111cm)

18.7"  
(47.5cm)

Filter prevents sediments  
and dirt from getting into  
sprinkler

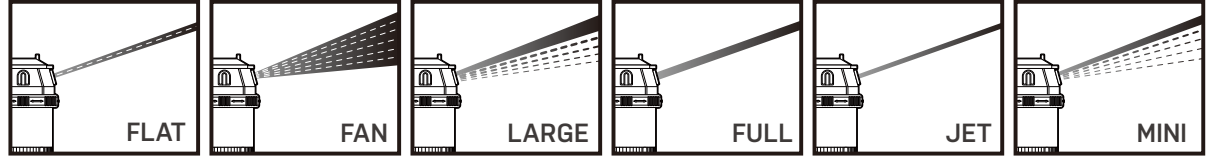
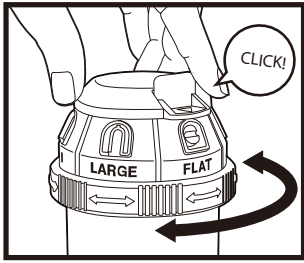

## Spray Pattern Adjustments

Depending on your watering needs, you can manually select from the various pattern settings:

Flat - The flat pattern will provide a flat wave of water.

Fan - The fan pattern disperses water in a wide fan shape.

Large - This provides a larger watering spray area.

Full - This pattern provides strong distance watering.

Jet - Concentrated far distance watering.

Mini - Provides gentle spray for delicate plants.

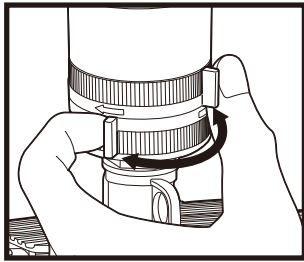

## Spray Angle Adjustment

Adjust the tabs to change the spray angle to fit your needs (from 5° up to 360°).

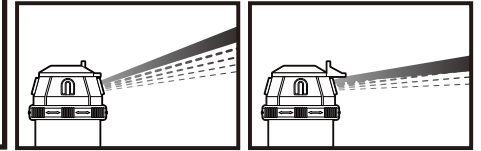
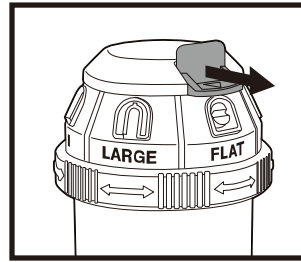

## Range Tab

Move the tab in or out to control the spray distance and water where it's needed.

## ⚠ CAUTION ⚠

- For outdoor use with cold water only
- Do not spray near electrical connections
- When not in use, rinse the tool with water to remove most of the dirt, dry your tool, and store indoors

**⚠ WARNING:** This product can expose you to chemicals including lead, which is known to the State of California to cause cancer and birth defects reproductive harm, and styrene which is known to the State of California to cause cancer. For more information go to [www.P65Warnings.ca.gov](http://www.P65Warnings.ca.gov)

The Premium Quick Connect with Shut Off Valve Set will simplify your watering experience. Attach the connector at the end of your hose. Then connect the adapters to your watering tools. Interchange various tools with a snap without turning off the water, as the shut-off valve of the connector will stop the water flow. No more kinking or hose twisting, as the connector allows you to swivel your hose 360 degrees.

