

# MISTING AND REVOLVING SPRINKLERS WITH TELESCOPING TRIPOD

Tripod length  
70"  
(179cm)

31.8"  
(81cm)

## Step 1

Place the tripod in the area where you want to water. Push down on the tripod legs until the spikes are well seated in the ground.

*(Follow the yellow warning sign on the tripod to avoid pinching your thumb)*

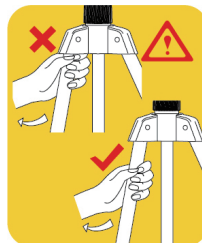

## Step 2

Simply attach the sprinkler head to the top of the Tripod (do not overtighten).



## Step 3

Using the Quick Connect with Shut Off Valve allows you to easily shut off the water and swap tools without having to return to the faucet – saving time and water. Attach the lockable Quick Connect to the end of the hose, then snap the hose to the tripod to begin using.

**Note:** If you are not using the Quick Connect System, simply connect the sprinkler directly to the hose.



## Features & Benefits

- Misting head features 360-degree horizontal angle adjustments, 200 degree vertical angle adjustments to water in any direction
- Easy to move and place anywhere in the yard
- No tools required to assemble! Hand tighten only
- 15 spray nozzles provide a dancing fountain watering effect
- Tripod adjusts from 31 inches to 70 inches (81 cm to 179 cm) for watering tall plants
- Great for cooling patios, balconies, and outdoor areas for relief during the summer heat, cooling mist refreshes hanging plants, potted plants, vases, herbs, and more

Quick Connect Starter Set with Shut Off Valve fits standard garden hoses and watering tools





#### Cleaning and Maintenance:

If you are not using a water filter and the Misting Tower has low water pressure, you may need to clean the misting nozzles. To clean, simply use your hand to unscrew the red nozzle caps. Carefully rinse all parts with a gentle water flow. Be mindful of all parts when cleaning. Cleaning should be done on a workbench to prevent losing parts.



Center fountain head nozzle creates fountain effect



Rotation angle changes both coverage & speed. Slow speed mode for big coverage; Fast speed for small coverage.

#### ⚠ CAUTION ⚠

- For outdoor use with cold water only
- Do not spray near electrical connections
- When not in use, rinse the tool with water to remove most of the dirt, dry your tool, and store indoors

**⚠ WARNING:** This product can expose you to chemicals including styrene which is known to the State of California to cause cancer. For more information go to [www.P65Warnings.ca.gov](http://www.P65Warnings.ca.gov).

